



PN 10

VALVOLE DI FONDO
FOOT VALVES

FIG. 472G

Valvole di fondo in Ghisa PN10 attacco flangiato
Cast Iron foot valves PN10 flangia ends

Materiali - Composition

| CORPO Body | OTTURATORE Disc | SEDI Seat Ring | Asta guida Slide bar | Succheruola Basket |
|--------------------|--------------------|--------------------------------|-------------------------|--------------------------------|
| GHISA Cast Iron | GHISA Cast Iron | GOMMA TELATA Special rubber | OTTONE Brass | ACC. ZINC. Galvanized Steel |

Applicazioni Application

Acqua , altri fluidi non aggressivi
Water, and other non-aggressive fluids

Pressione/temperatura di esercizio - Rating

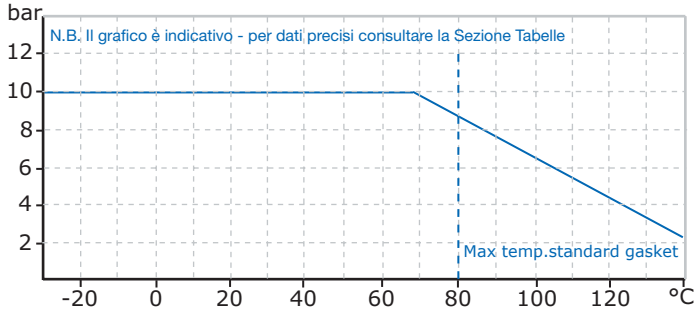
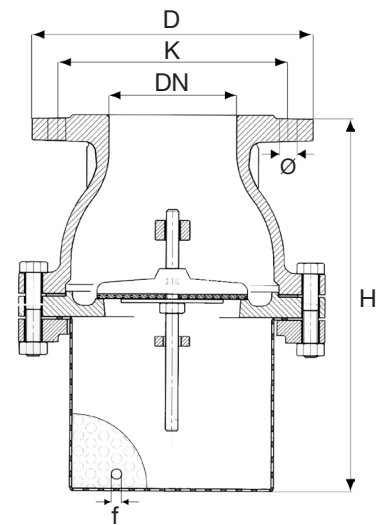

FIG. 472G



Dimensioni Dimensions mm.

| DN | 40 | 50 | 65 | 80 | 100 | 125 | 150 | 200 | 250 | 300 | | |
|----------------------------|-------|----------|-------|-------|-------|-------|-------|-------|--------|---------|---------|---------|
| H | 170 | 185 | 220 | 240 | 265 | 320 | 370 | 460 | 560 | 670 | | |
| f | 8 | 8 | 8 | 8 | 8 | 8 | 8 | 8 | 8 | 8 | | |
| Kg. | 6 | 8 | 10 | 12 | 17 | 25 | 32 | 52 | 97 | 144 | | |
| foratura Flange - drilling | PN 10 | D | 150 | 165 | 185 | 200 | 220 | 250 | 285 | 340 | 395 | 445 |
| | | K | 110 | 125 | 145 | 160 | 180 | 210 | 240 | 295 | 350 | 400 |
| | | Ø n.fori | 4 -18 | 4 -18 | 4 -18 | 8 -18 | 8 -18 | 8 -18 | 8 - 22 | 8 - 22 | 12 - 22 | 12 - 22 |
| | PN 16 | D | 150 | 165 | 185 | 200 | 220 | 250 | 285 | 340 | 405 | 460 |
| | | K | 110 | 125 | 145 | 160 | 180 | 210 | 240 | 295 | 355 | 410 |
| | | Ø n.fori | 4 -18 | 4 -18 | 4 -18 | 8 -18 | 8 -18 | 8 -18 | 8 - 22 | 12 - 22 | 12 - 26 | 12 - 26 |